



Purchasing Department
113 Mable T. Willis Blvd.
Walterboro, SC 29488
843.782.0504

BID: FR-25
MABLE T. WILLIS BLVD. FIRE STATION # 1
EXPANSION and RENOVATION

Due: Tuesday, September 15, 2020 at 11:00am

ADDENDUM 1
DATED: 09-08-2020

The following questions have been submitted for clarification:

1. Page S010 notes 1 and 3. Please verify that delegated design and engineering drawings and calculations are required. **Answer:** Yes.
2. Page P001, can PVC be used in lieu of cast iron for waste? **Answer:** Yes, PVC can be used in lieu of cast iron for waste.
3. Please verify that Builders Risk is required by the contractor. **Answer:** Yes, Builders Risk Insurance is required for the awarded contractor.
4. Please verify that the warranty period for the project is 730 days. **Answer:** Yes, as stated on page 17, **ARTICLE 23 – WARRANTY, section 23.01** *“Warranty of workmanship and products shall be covered for **730 days** from the date of the issuance of the Certificate of Substantial Completion.”*

Sheet AD100 – Demolition Floor Plan is attached.

LEGEND & SYMBOLS	
	EXISTING WALL TO BE DEMOLISHED
	EXISTING ITEM / AREA TO BE DEMOLISHED
	EXISTING DOOR TO BE DEMOLISHED
	EXISTING WINDOW TO BE DEMOLISHED

DEMOLITION CEILING NOTES	
1	COORDINATE DEMOLITION AND NEW WORK WITH ELECTRICAL / MECHANICAL / PLUMBING DRAWINGS.

GENERAL DEMOLITION CEILING NOTES	
1	REMOVE ALL CEILINGS, ASSOCIATED FRAMING, BLOCKING & SUPPORTS
2	REMOVE ALL LIGHTING FIXTURES, ASSOCIATED FRAMING, BLOCKING & SUPPORTS
3	REMOVE ALL ANNOUNCEMENT, LIFE SAFETY, SECURITY DEVICES, & ASSOCIATED WIRING

GENERAL DEMOLITION NOTES	
1	ELEMENTS OR PORTIONS OF ELEMENTS TO BE REMOVED ARE SHOWN DASHED. REFER TO KEY NOTES FOR ADDITIONAL CLARIFICATION FOR PARTIALLY REMOVED OR REUSED ELEMENTS. RETURN UN-USED DOORS, HARDWARE, AND ACCESSORIES TO OWNER.
2	VERIFY EXISTING CONDITIONS OF SPACE PRIOR TO DEMOLITION WORK.
3	AREAS OF DEMOLITION ARE APPROXIMATE. GENERAL CONTRACTOR TO COORDINATE TO COORDINATE DEMOLITION WITH EXISTING CONDITIONS, NEW CONSTRUCTION, AND ADDITIONAL SCOPE OF WORK INCLUDED IN MECHANICAL, PLUMBING, AND ELECTRICAL DOCUMENTS.
4	WALL DEMOLITION TO INCLUDE FRAMING, SHEATHING, FINISHES AND ALL APPURTENANCES.
5	ANY HIDDEN STRUCTURAL COLUMNS OR SUPPORT IS TO BE BROUGHT TO THE ATTENTION OF THE ARCHITECT PRIOR TO REMOVAL. ANY BUILDING SUPPORT WHICH DEVIATES FROM THAT SHOWN OR IS IN QUESTION IS TO BE BROUGHT TO ARCHITECT'S ATTENTION IMMEDIATELY.
6	REFER TO MECHANICAL, PLUMBING, AND ELECTRICAL DOCUMENTS FOR REMOVAL AND CAPPING OF SERVICES FOR ITEMS SHOWN TO BE REMOVED.
7	CONTRACTOR SHALL TAKE NECESSARY PRECAUTIONS TO PROTECT EXISTING FLOORING AND FINISHES TO REMAIN.
8	REMOVE ALL ABANDONED ACCESSORIES AND DEVICES NOT OTHERWISE NOTED. PATCH DRYWALL AND PREP FOR NEW FINISHES
9	CONTRACTOR SHALL BE RESPONSIBLE FOR SECURITY OF BUILDING CONTENTS AS WELL AS BUILDING MATERIALS STORED ON SITE DURING CONSTRUCTION.
10	DEMOLISH EXISTING ELECTRICAL DEVICES, CONDUIT AND CONDUCTORS IN WALLS TO BE REMOVED. ALL FEEDER CIRCUIT CONDUCTORS SHALL BE DEMOLISHED BACK TO PANEL. CONDUIT ABOVE CEILING BACK TO PANEL MAY BE REUSED AS COORDINATED WITH WORK FROM OTHER TRADES.
11	REFER TO CIVIL, STRUCTURAL, PLUMBING, MECHANICAL, ELECTRICAL FOR OTHER DEMOLITION. CONTRACTOR TO COORDINATE DEMOLITION REQUIRED BY OTHER DISCIPLINES AND COMPLETE PREPARATION FOR NEW WORK.
12	EXISTING CONSTRUCTION TO REMAIN SHALL BE PROTECTED DURING DEMOLITION AND NEW WORK CONSTRUCTION ACTIVITIES.
13	THE EXTENT OF DEMOLITION INDICATED IS BASED ON AS BUILT DRAWING PROVIDED BY THE OWNER AND FIELD OBSERVATIONS. ANY DISCREPANCIES BETWEEN ACTUAL CONDITIONS AND THOSE INDICATED ARE TO BE BROUGHT TO THE ATTENTION OF THE ARCHITECT AS SOON AS DISCREPANCIES ARE DISCOVERED.
14	DEMOLITION PLANS AND ELEVATIONS SHOW THE INTENT OF DEMOLITION TO BE PERFORMED. ALL DASHED ITEMS ARE TO BE DEMOLISHED COMPLETE. CONTRACTOR SHALL INCLUDE ALL DEMOLITION CUTTING AND PATCHING REQUIRED FOR NEW CONSTRUCTION. REFER TO OTHER DISCIPLINES (CIVIL STRUCTURAL, MECHANICAL, ELECTRICAL, PLUMBING AND FIRE PROTECTION) DEMOLITION DRAWINGS FOR ADDITIONAL ITEMS TO BE DEMOLISHED. THE CONTRACTOR SHALL REPORT ANY DISCREPANCIES BETWEEN DISCIPLINES DEMOLITION AND NEW WORK TO THE ARCHITECT. IT IS THE RESPONSIBILITY OF THE CONTRACTOR TO SHORE, BRACE AND/OR SECURE MATERIALS AND STRUCTURE TO REMAIN.
15	WHERE EXISTING WALL, CEILING, ROOF OR FLOOR SYSTEMS ARE TO REMAIN AND ARE DISTURBED BY DEMOLITION, THEY SHALL BE REPAIRED AS REQUIRED TO MATCH ORIGINAL INTEGRITY AND ADJACENT CONSTRUCTION.
16	CONTRACTOR TO REMOVE ALL ABANDONED OR UNNECESSARY PIPING, DUCT, WIRING CONDUIT AND/OR ANCHORS COMPLETE.



REV. NO.	DATE	DESCRIPTION

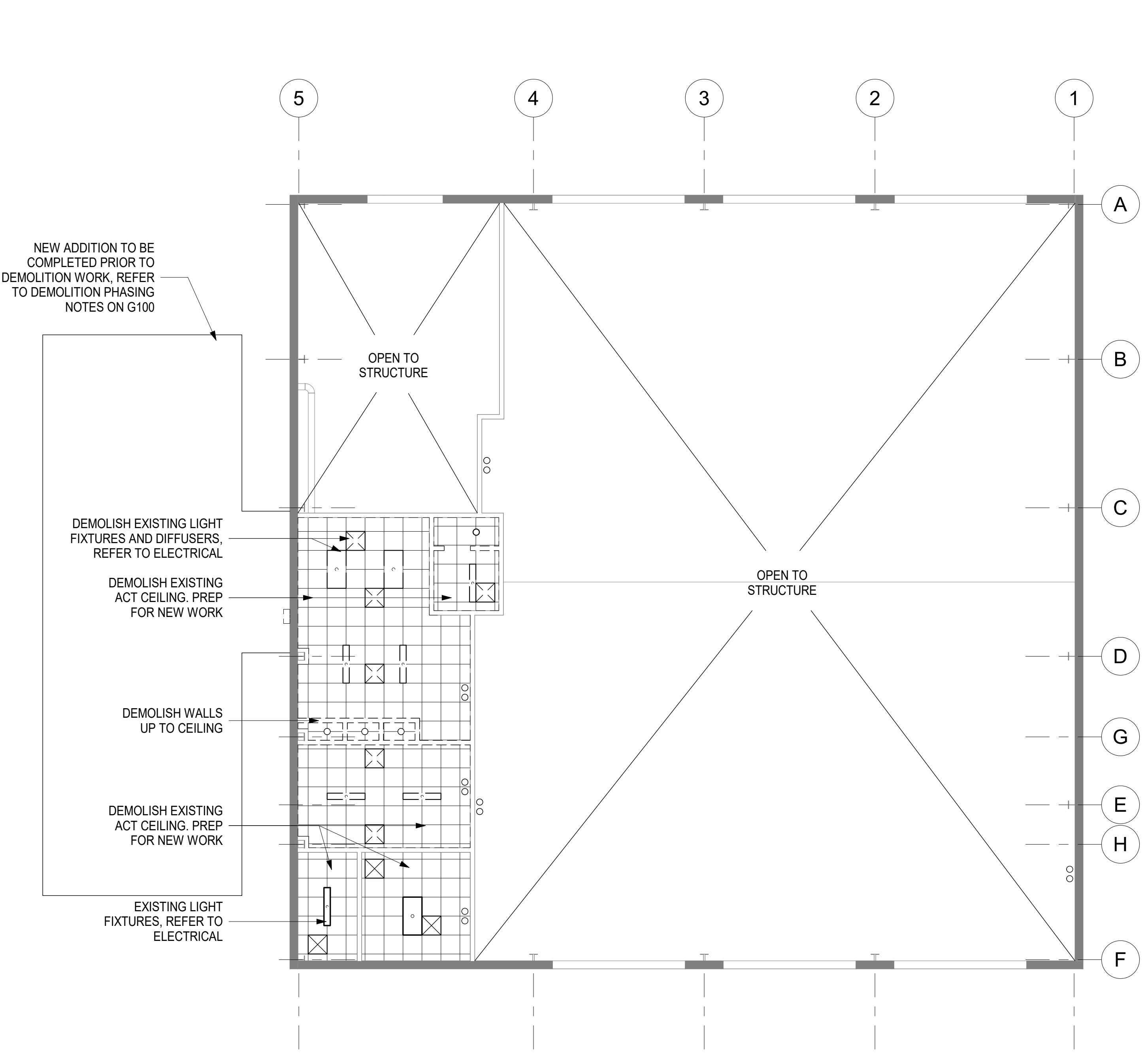
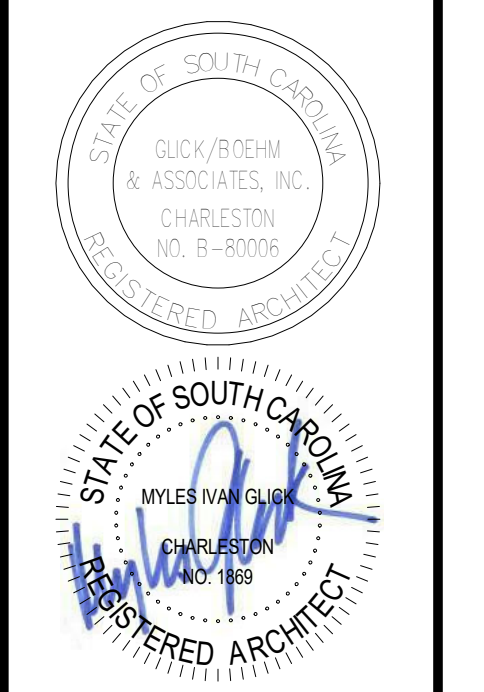

2 DEMOLITION FIRST FLOOR CEILING PLAN (PHASE IV)
AD100 SCALE: 1/8" = 1'-0"

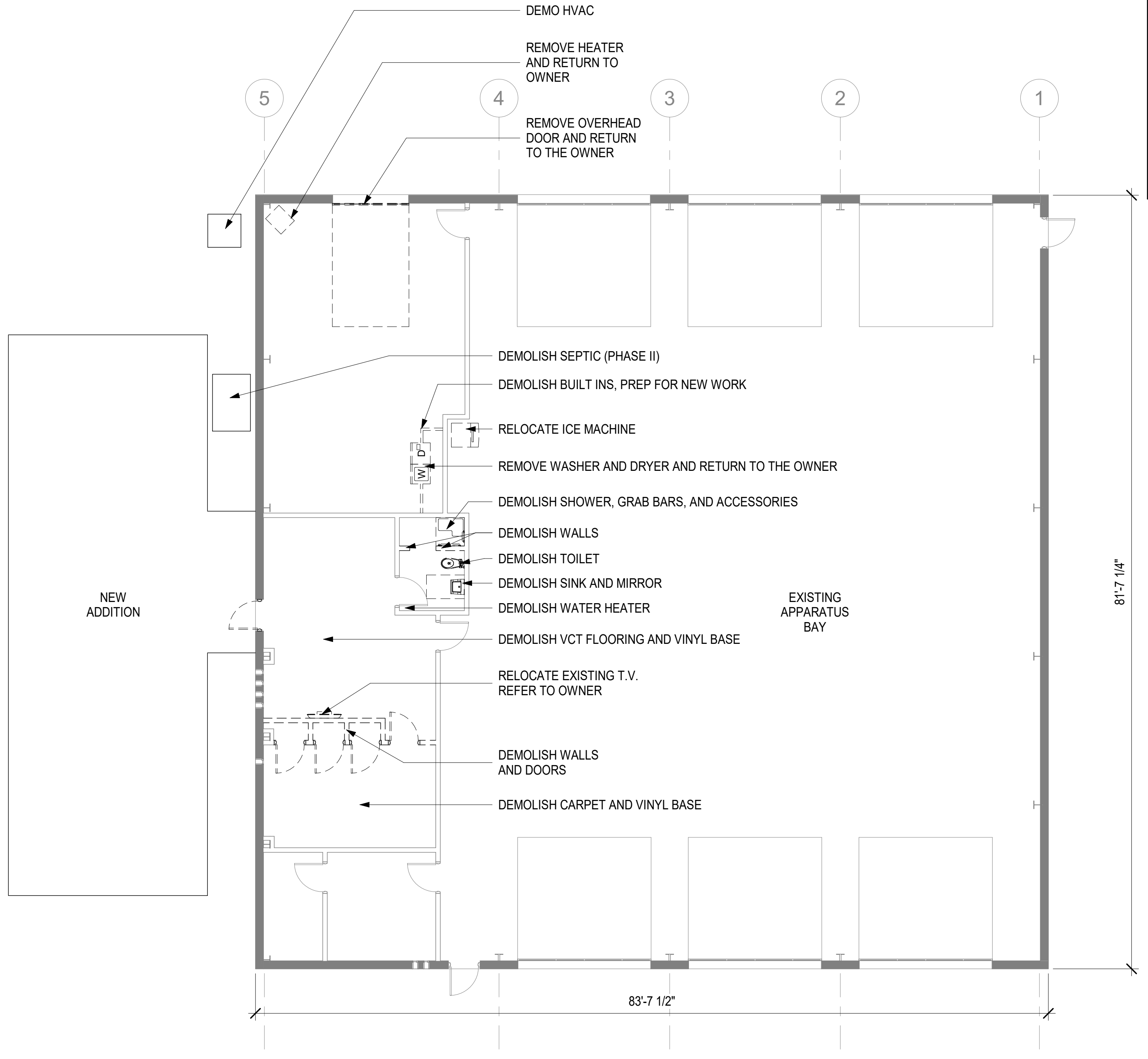

1 DEMOLITION FLOOR PLAN (PHASE IV)
AD100 SCALE: 1/8" = 1'-0"

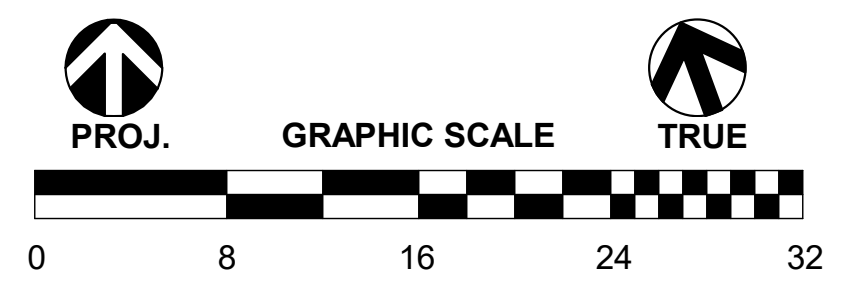

**COLLETON COUNTY FIRE STATION #1
ADDITION**
COLLETON COUNTY
229 MABLE T. WILLIS BLVD.
WALTERBORO, SC 29488

COPYRIGHT © 2020
GLICK/BOEHM & ASSOCIATES, INC.
JOB NUMBER: 1921
PROJECT MGR.: MCM
DRAWN BY: MCM
CHECKED BY: SM
APPROVED BY: GBA
DATE ISSUED FOR CONSTRUCTION DOCUMENTS: 07/22/2020

DEMOLITION FLOOR PLANS

AD100