

MEADWESTVACO FORESTRY LLC  
TMS 184-00-00-001  
DEED BOOK 1011 PAGE 172  
PORTION OF RESIDUAL

MAGGIE H & ALEX GEORGE  
TMS 184-00-00-029  
PB 20 PAGE 57

VICINITY MAP (NTS)

SITE STATISTICS:

- TOTAL AREA = 1.99 ACRES
- PROPOSED IMPERVIOUS AREA (BUILDING & PAVEMENT) = 0.14 ACRES
- % IMPERVIOUS = 7.03 %

SEDIMENT & EROSION CONTROL NOTES:

CAROLINA ENGINEERING CONSULTANTS, INC.'S WRITTEN CONSTRUCTION SPECIFICATIONS WILL BE FOLLOWED ON THIS JOB. IF CONTRACTOR NEEDS COPY OF THESE SPECIFICATIONS, PLEASE CONTACT CAROLINA ENGINEERING.

PRIOR TO STARTING ANY PHASE OF CONSTRUCTION INSTALL THE TEMPORARY SILT FENCE.

IMMEDIATELY AFTER INSTALLATION OF THE SILT FENCE, CONSTRUCT THE STORMWATER DETENTION POND & OUTFALL STRUCTURE TO SERVE AS THE SEDIMENTATION POND DURING CONSTRUCTION. ONCE CONSTRUCTION IS COMPLETE, REGRADE THE DETENTION POND TO THE PROPOSED FINISHED GRADE ELEVATIONS AND STABILIZE WITH GRASS SEED. SEDIMENTATION BASIN SHALL BE STABILIZED IMMEDIATELY AFTER INSTALLATION.

PROTECT ALL CATCH BASINS AND CURB INLETS WITH PROPER SILT FENCE OR OTHER INLET PROTECTION METHODS (SEE DRAINAGE DETAILS).

IF NECESSARY, SLOPES, WHICH EXCEED EIGHT (8) VERTICAL FEET SHOULD BE STABILIZED WITH SYNTHETIC OR VEGETATIVE MATS, IN ADDITION TO HYDROSEEDING. IT MAY BE NECESSARY TO INSTALL TEMPORARY SLOPE DRAINS DURING CONSTRUCTION. TEMPORARY BERMS MAY BE NEEDED UNTIL THE SLOPE IS BROUGHT TO GRADE.

STABILIZATION MEASURES SHALL BE INITIATED AS SOON AS PRACTICABLE IN PORTIONS OF THE SITE WHERE CONSTRUCTION ACTIVITIES HAVE TEMPORARILY OR PERMANENTLY CEASED, BUT IN NO CASE MORE THAN FOURTEEN (14) DAYS AFTER WORK HAS CEASED, EXCEPT AS STATED BELOW.

WHERE STABILIZATION BY THE 14TH DAY IS PRECLUDED BY SNOW COVER OR FROZEN GROUND CONDITIONS STABILIZATION MEASURES MUST BE INITIATED AS SOON AS PRACTICABLE.

WHERE CONSTRUCTION ACTIVITY ON A PORTION OF THE SITE IS TEMPORARILY CEASED, AND EARTH-DISTURBING ACTIVITIES WILL BE RESUMED WITHIN 14 DAYS, TEMPORARY STABILIZATION MEASURES DO NOT HAVE TO BE INITIATED ON THAT PORTION OF THE SITE.

ALL SEDIMENT AND EROSION CONTROL DEVICES SHALL BE INSPECTED EVERY SEVEN (7) DAYS. IF SITE INSPECTIONS IDENTIFY BMPs THAT ARE DAMAGED OR ARE NOT OPERATING EFFECTIVELY, MAINTENANCE MUST BE PERFORMED AS SOON AS PRACTICAL OR AS REASONABLY POSSIBLE AND BEFORE THE NEXT STORM EVENT WHENEVER PRACTICABLE.

PROVIDE SILT FENCE AND/OR OTHER CONTROL DEVICES, AS MAY BE REQUIRED, TO CONTROL SOIL EROSIONS DURING UTILITY CONSTRUCTION. ALL DISTURBED AREAS SHALL BE CLEARED, GRADED, AND STABILIZED WITH GRASSING IMMEDIATELY AFTER THE UTILITY INSTALLATION. FILL COVER, AND TEMPORARY SEEDING AT THE END OF EACH DAY ARE RECOMMENDED. IF WATER IS ENCOUNTERED WHILE TRENCHING, THE WATER SHOULD BE FILTERED TO REMOVE ANY SEDIMENTS BEFORE BEING PUMPED BACK INTO ANY WATERS OF THE STATE.

ALL EROSION CONTROL DEVICES SHALL BE PROPERLY MAINTAINED DURING ALL PHASES OF CONSTRUCTION UNTIL THE COMPLETION OF ALL CONSTRUCTION ACTIVITIES AND ALL DISTURBED AREAS HAVE BEEN STABILIZED. ADDITIONAL CONTROL DEVICES MAY BE REQUIRED DURING CONSTRUCTION IN ORDER TO CONTROL EROSION AND/OR OFFSITE SEDIMENTATION. ALL TEMPORARY CONTROL DEVICES SHALL BE REMOVED ONCE CONSTRUCTION IS COMPLETE AND THE SITE IS STABILIZED.

THE CONTRACTOR MUST TAKE NECESSARY ACTION TO MINIMIZE THE TRACKING OF MUD ONTO PAVED ROADWAY(S) FROM CONSTRUCTION AREAS AND THE GENERATION OF DUST. THE CONTRACTOR SHALL DAILY REMOVE MUD/SOIL FROM PAVEMENT, AS MAY BE REQUIRED.

RESIDENTIAL SUBDIVISIONS REQUIRE EROSION CONTROL FEATURES FOR INFRASTRUCTURE AS WELL AS FOR INDIVIDUAL LOT CONSTRUCTION. INDIVIDUAL PROPERTY OWNERS SHALL FOLLOW THESE PLANS DURING CONSTRUCTION OR OBTAIN APPROVAL OF AN INDIVIDUAL PLAN IN ACCORDANCE WITH SC REGULATIONS 72-300 ET SEQ AND SCRI00000.

TEMPORARY DIVERSION BERMS AND/OR DITCHES WILL BE PROVIDED AS NEEDED DURING CONSTRUCTION TO PROTECT WORK AREAS FROM UPSLOPE RUNOFF AND/OR TO DIVERT SEDIMENT-LADEN WATER TO APPROPRIATE TRAPS OR STABLE OUTLETS.

ALL WATERS OF THE STATE (WOS), INCLUDING WETLANDS, ARE TO BE FLAGGED OR OTHERWISE CLEARLY MARKED IN THE FIELD. A DOUBLE ROW OF SILT FENCE IS TO BE INSTALLED IN ALL AREAS WHERE A 50-FOOT BUFFER CAN'T BE MAINTAINED BETWEEN THE DISTURBED AREA AND ALL WOS. A 10-FOOT BUFFER SHOULD BE MAINTAINED BETWEEN THE LAST ROW OF SILT FENCE AND ALL WOS.

LITTER, CONSTRUCTION DEBRIS, OILS, FUELS, AND BUILDING PRODUCTS WITH SIGNIFICANT POTENTIAL FOR IMPACT (SUCH AS STOCKPILES OF FRESHLY TREATED LUMBER) AND CONSTRUCTION CHEMICALS THAT COULD BE EXPOSED TO STORM WATER MUST BE PREVENTED FROM BECOMING A POLLUTANT SOURCE IN STORM WATER DISCHARGES.

CONTRACTOR SHALL BE RESPONSIBLE FOR STABILIZATION OF ALL DISTURBED AREAS WITHIN THE PROJECT LIMITS WITH MULCHING/PERMANENT VEGETATION.

3 DAYS BEFORE DIGGING IN SOUTH CAROLINA  
CALL 1-888-721-7877  
PALMETTO UTILITY PROTECTION SERVICE

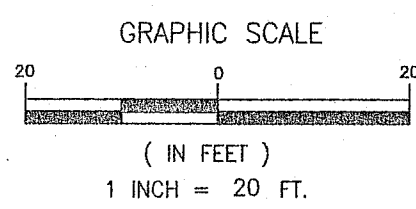

IONS CROSS ROADS  
FIRE & RESCUE  
SUBSTATION  
ROUND O ROAD  
COLLETON COUNTY  
SOUTH CAROLINA  
COLLETON COUNTY

CAROLINA ENGINEERING  
P.O. BOX 294  
BEAUFORT, S.C. 29901  
(843) 322-0553

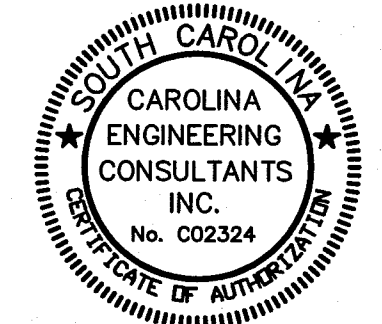
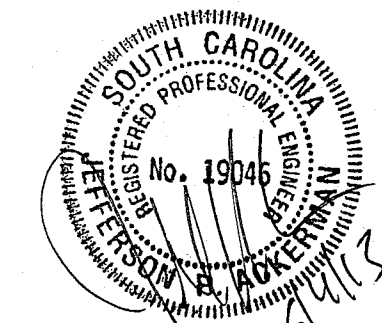

CONSULTANTS

SHEET

| MARK                    | DATE   | PERMIT DESCRIPTION |
|-------------------------|--------|--------------------|
|                         | 6-7-12 | PERMIT             |
| PROJECT NO: 2012.019.00 |        |                    |
| MODEL FILE:             |        |                    |
| DRAWN BY: TAB           |        |                    |
| CHK'D BY: JPA           |        |                    |
| DATE: 06-03-2013        |        |                    |

SHEET TITLE

CLEARING, TREE AND  
EROSION & SEDIMENT  
CONTROL



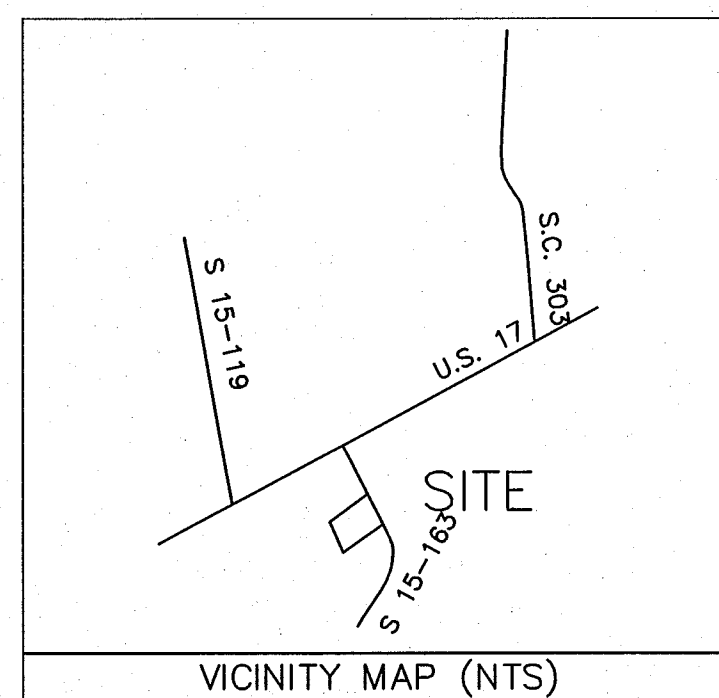

MEADWESTVACO FORESTRY LLC  
TMS 184-00-00-001  
DEED BOOK 1011 PAGE 172  
PORTION OF RESIDUAL

MAGGIE H & ALEX GEORGE  
TMS 184-00-00-029  
PB 20 PAGE 57

### GENERAL NOTES, PAVING, GRADING & DRAINAGE NOTES:

CAROLINA ENGINEERING CONSULTANTS, INC.'S WRITTEN CONSTRUCTION SPECIFICATIONS WILL BE FOLLOWED ON THIS JOB. IF CONTRACTOR NEEDS COPY OF THESE SPECIFICATIONS, PLEASE CONTACT CAROLINA ENGINEERING.

BENCHMARKS ARE TO BE VERIFIED BY CONTRACTOR.

CONTRACTOR SHALL VERIFY ALL MANHOLE AND INVERT ELEVATIONS BEFORE STARTING WORK.

CONTRACTOR IS RESPONSIBLE FOR LOCATING ALL EXISTING UTILITIES.

SILT FENCE AND TREE FENCES TO BE IN PLACE PRIOR TO COMMENCING WORK.

WHERE NEW CONSTRUCTION IS NEAR THE EDGE OF AN EXISTING PAVED ROADWAY, A TRAFFIC LANE WILL BE TEMPORARILY CLOSED TO PROVIDE SAFETY TO THE PUBLIC AND TO THE WORKMEN. NO LANE CLOSURES DURING 7:00 AM TO 9:00 AM OR FROM 3:30 PM TO 6:00 PM ARE ALLOWED.

APPLICANT WILL REPAIR ALL DAMAGE DONE TO ROADSIDE AND RESEED WITH PERMANENT GRASS.

TRAFFIC CONTROLS FOR THIS INSTALLATION SHALL BE IN ACCORDANCE WITH S.C.M.U.T.C.D.

PAVEMENT MARKING LINES TO BE THERMOPLASTIC.

RAISED REFLECTIVE PAVEMENT MARKER RRP'S TO BE INSTALLED IN ACCORDANCE WITH SCDOT'S STANDARD DRAWINGS NO. 603-1 THRU 603-8 JULY, 1997.

3 DAYS BEFORE DIGGING IN SOUTH CAROLINA  
CALL 1-888-721-7877  
PALMETTO UTILITY PROTECTION SERVICE

## IONS CROSS ROADS FIRE & RESCUE SUBSTATION

ROUND O ROAD  
COLLETON COUNTY  
SOUTH CAROLINA

COLLETON COUNTY

CAROLINA ENGINEERING  
P.O. BOX 294  
BEAUFORT, S.C. 29901  
(843) 322-0553

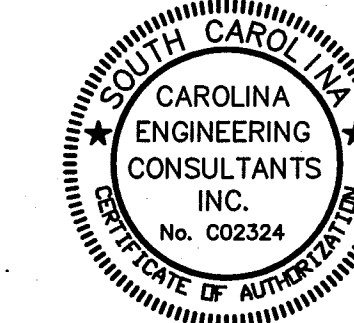
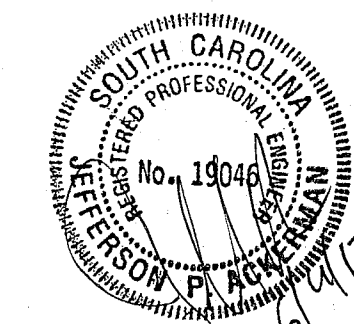

### CONSULTANTS

| MARK | DATE   | DESCRIPTION |
|------|--------|-------------|
|      | 6-7-12 | PERMIT      |

PROJECT NO: 2012.019.00  
MODEL FILE:  
DRAWN BY: TAB  
CHK'D BY: JPA  
DATE: 06-03-2013

### SHEET TITLE

PAVING & GRADING  
PLAN

C2

SHEET 4 OF 24

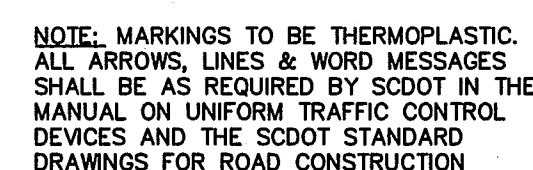

COLLETON COUNTY

CAROLINA ENGINEERING  
P.O. BOX 294  
BEAUFORT, S.C. 29901  
(843) 322-0553

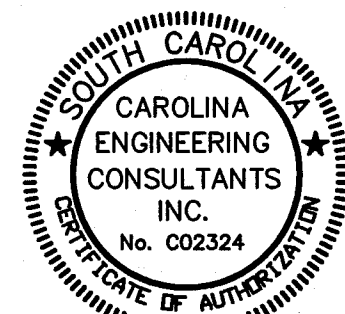

CONSULTANTS

|                         |        |             |
|-------------------------|--------|-------------|
|                         |        |             |
|                         |        |             |
|                         |        |             |
|                         |        |             |
|                         |        |             |
|                         | 6-7-12 | PERMIT      |
| MARK                    | DATE   | DESCRIPTION |
| PROJECT NO: 2012.019.00 |        |             |
| MODEL FILE:             |        |             |
| DRAWN BY: TAB           |        |             |
| CHK'D BY: JPA           |        |             |
| DATE:                   |        | 06-03-2013  |

**SHEET TITLE**

## SITE DETAILS

C3



