

S.C. 63 SNIDERS HWY.

**SITE**

MABEL T. WILLIS BLVD.

S 15-782

APPROXIMATE  
LOCATION OF SITE:  
LONGITUDE: 80° 41' 47"  
LATITUDE: 32° 52' 59"

APPROXIMATE  
LOCATION OF SITE:  
LONGITUDE: 80° 41' 47"  
LATITUDE: 32° 52' 59"

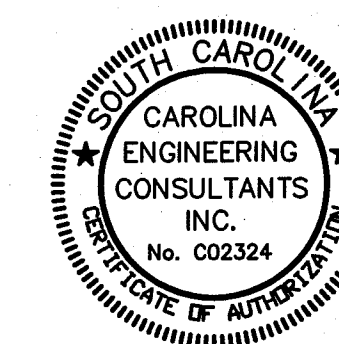

A circular professional engineer seal for the State of South Carolina. The outer ring contains the text "SOUTH CAROLINA" at the top and "REGISTERED PROFESSIONAL ENGINEER" at the bottom. In the center, it says "No. 19826". Below the number, the name "DAVID R. SMITH" is partially visible. A handwritten signature is written over the seal, and the number "19826" is handwritten at the bottom right.

CONTRACTOR TO IDENTIFY & LOCATE ALL UNDERGROUND UTILITIES PRIOR TO STARTING CONSTRUCTION.

CONTRACTOR RESPONSIBLE FOR TRAFFIC CONTROL & SAFETY DURING CONSTRUCTION.

CONTRACTOR RESPONSIBLE FOR SECURING SITE DURING NON-WORKING HOURS TO ENSURE TRAFFIC & PEDESTRIAN SAFETY

DATE: 02/15/13  
REVISED: 08/09/13  
PROJECT: 1592

**(843)322-0553**  
**(843)322-0556 (FAX)**

3 DAYS BEFORE DIGGING IN SOUTH CAROLINA  
CALL 1-888-721-7877  
PALMETTO UTILITY PROTECTION SERVICE

SHEET NO.	DESCRIPTION
1 of 10	TITLE SHEET
2 of 10	INDEX SHEET
3 of 10	DEMOLITION PLAN
4 of 10	TREE PROTECTION & REMOVAL PLAN SEDIMENT & EROSION CONTROL PLAN
5 of 10	TREE PROTECTION & REMOVAL PLAN SEDIMENT & EROSION CONTROL PLAN
6 of 10	SEDIMENT & EROSION CONTROL DETAILS
7 of 10	SITE DEVELOPMENT PLAN
8 of 10	SITE DEVELOPMENT PLAN
9 of 10	PAVING, GRADING & DRAINAGE DETAILS
10 of 10	WATER & SANITARY SEWER DETAILS



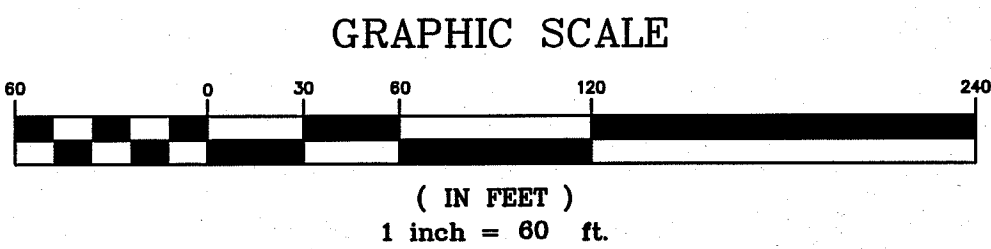
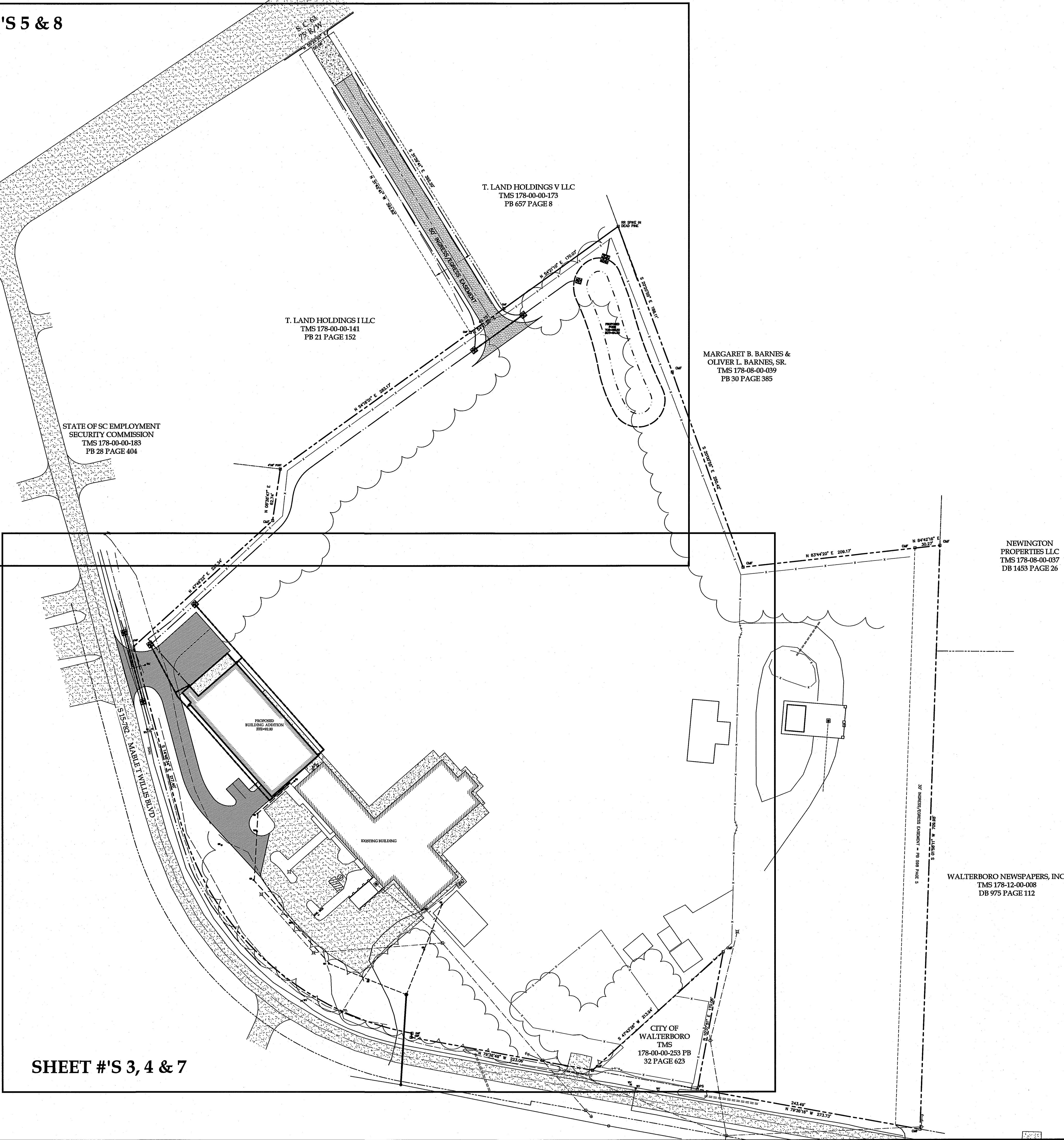

PLAN REVISIONS	
NO.	DESCRIPTION
1	
2	
3	
4	
5	
6	
7	
8	

CAROLINA  
ENGINEERING  
CONSULTANTS  
INC.  
No. 002224  
CERTIFICATE OF REGISTRATION

CAROLINA  
ENGINEERING  
CONSULTANTS  
INC.  
No. 002224  
CERTIFICATE OF REGISTRATION

\*ANY INFRINGEMENT MAY BE SUBJECT TO LEGAL ACTION.  
THE DESIGNS AND IDEAS PRESENTED IN THESE  
DRAWINGS ARE THE PROPERTY OF THE ENGINEER.  
REPRODUCTION, COPY, OR USE OF THESE PLANS OR THE  
INFORMATION IS STRICTLY PROHIBITED WITHOUT THE  
WRITTEN CONSENT OF THE ENGINEER.

FIRE & RESCUE  
MABEL T. WILLIS BLVD.  
COLLETON COUNTY, SC

CAROLINA ENGINEERING CONSULTANTS, INC.  
PO BOX 294  
BEAUFORT, SC 29901  
WWW.CAROLINAENGINEERING.COM  
843/322-0553  
843/322-0556 (FAX)

PROJECT:	1592
DATE:	02/15/13
REVISED:	07/02/13
DRAWN BY:	TAB
ENGINEER:	JPA
SCALE:	1"=60'





EXISTING 18" RCP TO BE REMOVED  
SAW CUT ASPHALT EDGE  
PRIOR TO REMOVAL  
SIGN TO BE RELOCATED TO BE  
CLEAR OF PROPOSED ASPHALT  
EXISTING ASPHALT PAVING  
& BASE TO BE REMOVED (TYP)  
PORTION OF EXISTING  
4" PVC PIPE  
TO BE REMOVED  
EXISTING FENCE GATE  
TO BE RELOCATED  
EXISTING 6" CHAIN LINK FENCE  
TO BE REMOVED (TYP)  
SEPTIC TANK & DRAINFIELD TO BE REMOVED  
PER SCDHEC REGULATIONS  
(TANK TO BE LOCATED BY CONTRACTOR)  
LIGHT POLE AND OVER HEAD LINE  
TO BE RELOCATED (BY OTHERS)

ONE STORY METAL  
AND BLOCK BLDG.  
FFE = 91.5

GRATE INLET  
RIM=87.85  
INV=86.61

6" PVC TERMINUS UNK.

SEPTIC TANK & DRAINFIELD TO BE REMOVED  
PER SCDHEC REGULATIONS  
(TANK TO BE LOCATED BY CONTRACTOR)

CITY OF WALTERBORO  
TMS 178-00-00-253  
B 32 PAGE 623

18" RCP  
INVus=82.09  
INVds=80.12

18" RCP  
INVus=82.31  
INVds=82.23

18" RCP  
INVus=78.00  
INVds=77.46

GRAPHIC SCALE

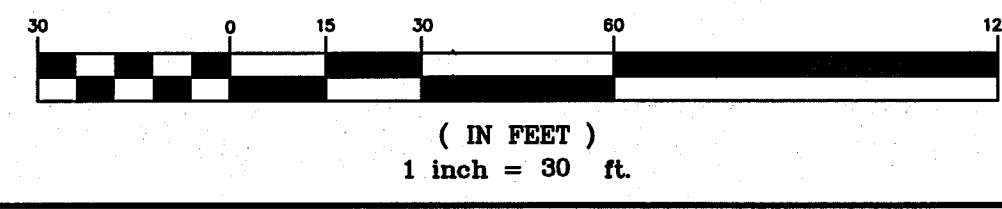

Professional Seal

Professional Engineer

JEFFREY W. JONES

No. 19046

State of South Carolina

Professional Seal

Professional Engineer

JEFFREY W. JONES

No. 002324

State of South Carolina

Professional Seal

Professional Engineer

JEFFREY W. JONES

No. 19046

State of South Carolina

Professional Seal

Professional Engineer

JEFFREY W. JONES

No. 002324

State of South Carolina

\*ANY INFRINGEMENT MAY BE SUBJECT TO LEGAL ACTION.  
DRAWINGS ARE THE PROPERTY OF SAID ENGINEER. THE  
REPRODUCTION, COPY, OR USE OF THESE PLANS OR THE  
INFORMATION IS STRICTLY PROHIBITED WITHOUT THE  
WRITTEN CONSENT OF THE ENGINEER.

PLAN REVISIONS	
NO.	DESCRIPTION
1	
2	
3	
4	
5	
6	
7	
8	

**FIRE & RESCUE**

**MABEL T. WILLIS BLVD.**

**COLLETON COUNTY, SC**

**CAROLINA ENGINEERING CONSULTANTS, INC.**

PO BOX 294

BEAUFORT, SC 29901

843/322-0553

843/322-0556 (FAX)

WWW.CAROLINAENGINEERING.COM

PROJECT: 1592

DATE: 02/15/13

REVISED: 07/02/13

DRAWN BY: TAB

ENGINEER: JPA

SCALE: 1"=30'

DEMOLITION  
PLAN

3  
OF 10



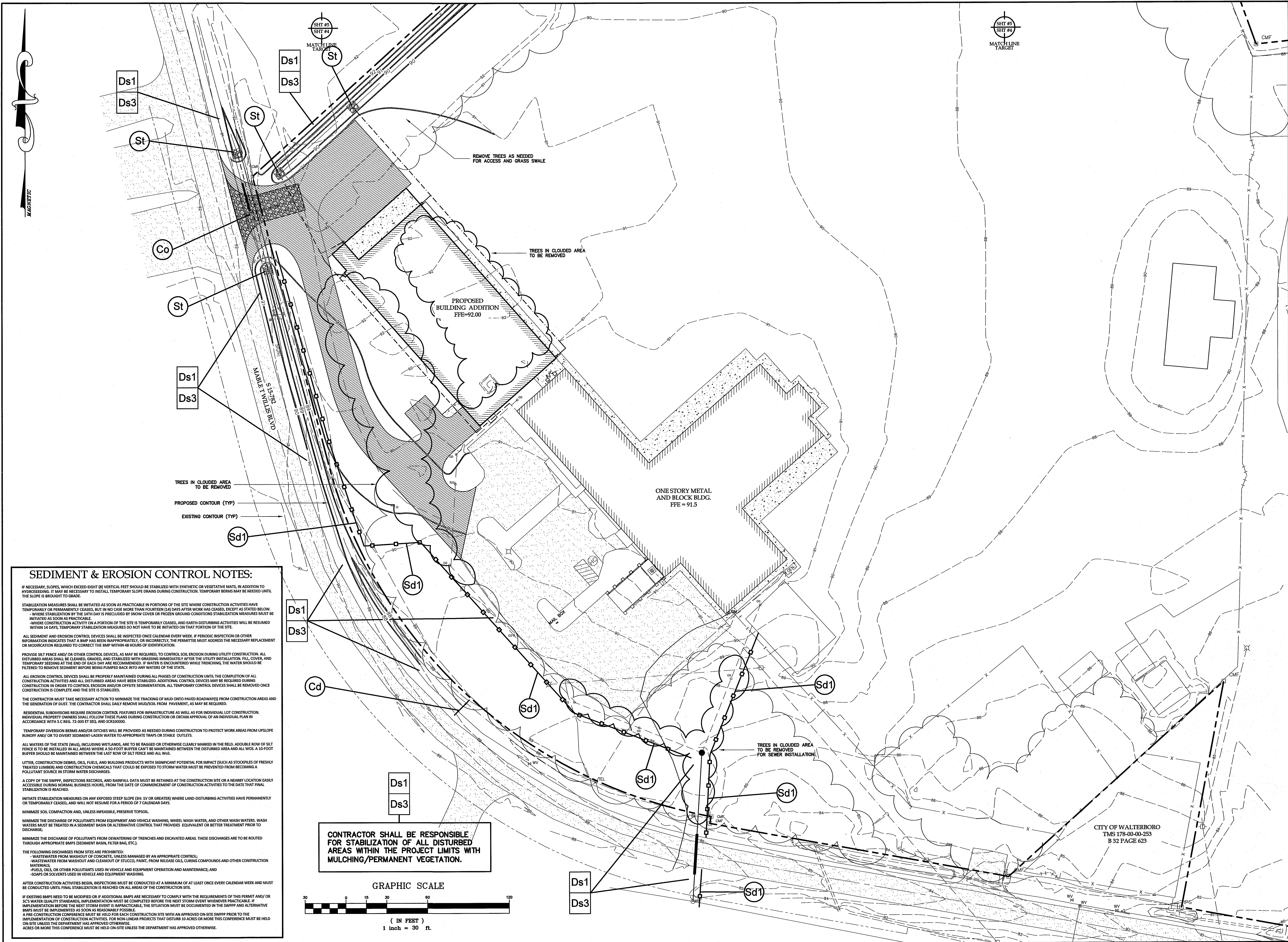

### SEDIMENT & EROSION CONTROL NOTES:

IF NECESSARY, SLOPES, WHICH EXCEED EIGHT (8) VERTICAL FEET SHOULD BE STABILIZED WITH SYNTHETIC OR VEGETATIVE MATS, IN ADDITION TO HYDROSEEDING. IT MAY BE NECESSARY TO INSTALL TEMPORARY SLOPE DRAINAGE DURING CONSTRUCTION. TEMPORARY BERMS MAY BE NEEDED UNTIL THE SLOPE IS BROUGHT TO GRADE.

STABILIZATION MEASURES SHALL BE INITIATED AS SOON AS PRACTICABLE IN PORTIONS OF THE SITE WHERE CONSTRUCTION ACTIVITIES HAVE TEMPORARILY OR PERMANENTLY CEASED, BUT IN NO CASE MORE THAN FOURTEEN (14) DAYS AFTER WORK HAS CEASED, EXCEPT AS STATED BELOW.

WHERE STABILIZATION BY THE FIFTH DAY IS PRECLUDED BY SNOW COVER OR FROZEN GROUND, CONDITIONS STABILIZATION MEASURES MUST BE INITIATED AS SOON AS PRACTICABLE.

WHERE CONSTRUCTION ACTIVITY ON A PORTION OF THE SITE IS TEMPORARILY CEASED, AND EARTH-DISTURBING ACTIVITIES WILL BE RESUMED WITHIN 14 DAYS, TEMPORARY STABILIZATION MEASURES DO NOT HAVE TO BE INITIATED ON THAT PORTION OF THE SITE.

ALL SEDIMENT AND EROSION CONTROL DEVICES SHALL BE INSPECTED ONCE A CALENDAR EVERY WEEK. IF PERIODIC INSPECTION OR OTHER INFORMATION INDICATES THAT A BMP HAS BEEN INAPPROPRIATELY, OR INCORRECTLY, THE PERMITTEE MUST ADDRESS THE NECESSARY REPLACEMENT OR MODIFICATION REQUIRED TO CORRECT THE BMP WITHIN 48 HOURS OF IDENTIFICATION.

PROVIDE SILT FENCES AND/OR OTHER CONTROL DEVICES, AS MAY BE REQUIRED, TO CONTROL SOIL EROSION DURING UTILITY CONSTRUCTION. ALL DISTURBED AREAS SHALL BE CLEANED, GRADED, AND STABILIZED WITH GRASSING IMMEDIATELY AFTER THE UTILITY INSTALLATION. FILL, COVER, AND TEMPORARY SEEDING AT THE END OF EACH DAY ARE RECOMMENDED. IF WATER IS ENCOUNTERED WHILE TRENCHING, THE WATER SHOULD BE FILTERED TO REMOVE SEDIMENT BEFORE BEING PUMPED BACK INTO ANY WATERS OF THE STATE.

ALL EROSION CONTROL DEVICES SHALL BE PROPERLY MAINTAINED DURING ALL PHASES OF CONSTRUCTION UNTIL THE COMPLETION OF ALL CONSTRUCTION ACTIVITIES AND ALL DISTURBED AREAS HAVE BEEN STABILIZED. ADDITIONAL CONTROL DEVICES MAY BE REQUIRED DURING CONSTRUCTION IN ORDER TO CONTROL EROSION AND/OR OFFSITE SEDIMENTATION. ALL TEMPORARY CONTROL DEVICES SHALL BE REMOVED ONCE CONSTRUCTION IS COMPLETE AND THE SITE IS STABILIZED.

THE CONTRACTOR MUST TAKE NECESSARY ACTION TO MINIMIZE THE TRACKING OF MUD ONTO PAVED ROADWAYS FROM CONSTRUCTION AREAS AND THE GENERATION OF DUST. THE CONTRACTOR SHALL DAILY REMOVE MUD/SOIL FROM PAVEMENT, AS MAY BE REQUIRED.

RESIDENTIAL SUBDIVISIONS REQUIRE EROSION CONTROL FEATURES FOR INFRASTRUCTURE AS WELL AS FOR INDIVIDUAL LOT CONSTRUCTION. INDIVIDUAL PROPERTY OWNERS SHALL FOLLOW THESE PLANS DURING CONSTRUCTION OR OBTAIN APPROVAL OF AN INDIVIDUAL PLAN IN ACCORDANCE WITH S.C. REG. 72-500 S.E.O. AND S.C. REG. 72-500 S.E.O.

TEMPORARY DIVERSION BERMS AND/OR DITCHES WILL BE PROVIDED AS NEEDED DURING CONSTRUCTION TO PROTECT WORK AREAS FROM UPSLOPE RUNOFF AND/OR TO DIVERT SEDIMENT-LOADED WATER TO APPROPRIATE TRAPS OR STABLE OUTLETS.

ALL WATERS OF THE STATE (WOS), INCLUDING WETLANDS, ARE TO BE BAGGED OR OTHERWISE CLEARLY MARKED IN THE FIELD. A DOUBLE ROW OF SILT FENCE IS TO BE INSTALLED IN ALL AREAS WHERE A 50-FOOT BUFFER CAN'T BE MAINTAINED BETWEEN THE DISTURBED AREA AND ALL WOS. A 10-FOOT BUFFER SHOULD BE MAINTAINED BETWEEN THE LAST ROW OF SILT FENCE AND ALL WOS.

LITTER, CONSTRUCTION DEBRIS, OILS, FUELS, AND BUILDING PRODUCTS WITH SIGNIFICANT POTENTIAL FOR IMPACT (SUCH AS STOCKPILES OF FRESHLY TREATED LUMBER) AND CONSTRUCTION CHEMICALS THAT COULD BE EXPOSED TO STORM WATER MUST BE PREVENTED FROM BECOMING A POLLUTANT SOURCE IN STORM WATER DISCHARGES.

A COPY OF THE SWPPP, INSPECTION RECORDS, AND RAINFALL DATA MUST BE RETAINED AT THE CONSTRUCTION SITE OR A NEARBY LOCATION EASILY ACCESSIBLE DURING NORMAL BUSINESS HOURS, FROM THE DATE OF COMMENCEMENT OF CONSTRUCTION ACTIVITIES TO THE DATE THAT FINAL STABILIZATION IS REACHED.

INITIATE STABILIZATION MEASURES ON ANY EXPOSED STEEP SLOPE (8%: 1V OR GREATER) WHERE LAND-DISTURBING ACTIVITIES HAVE PERMANENTLY OR TEMPORARILY CEASED, AND WILL NOT RESUME FOR A PERIOD OF 7 CALENDAR DAYS.

MINIMIZE SOIL COMPACTION AND, UNLESS INFEASIBLE, PRESERVE TOPSOIL.

MINIMIZE THE DISCHARGE OF POLLUTANTS FROM EQUIPMENT AND VEHICLE WASHING, WHEEL WASH WATER, AND OTHER WASH WATERS. WASH WATERS MUST BE TREATED IN A SEDIMENT BASIN OR ALTERNATIVE CONTROL THAT PROVIDES EQUIVALENT OR BETTER TREATMENT PRIOR TO DISCHARGE.

MINIMIZE THE DISCHARGE OF POLLUTANTS FROM DEWATERING OF TRENCHES AND EXCAVATED AREAS. THESE DISCHARGES ARE TO BE ROUTED THROUGH APPROPRIATE BMPs (SEDIMENT BASIN, FILTER BAG, ETC.).

THE FOLLOWING DISCHARGES FROM SITES ARE PROHIBITED:

- WASTEWATER FROM WASHOUT OF CONCRETE, UNLESS MANAGED BY AN APPROPRIATE CONTROL;
- WASTEWATER FROM WASHOUT AND CLEANOUT OF STUCCO, PAINT, FROM RELEASE OILS, DURING COMPOUNDS AND OTHER CONSTRUCTION MATERIALS;
- FUELS, OILS, OR OTHER POLLUTANTS USED IN VEHICLE AND EQUIPMENT OPERATION AND MAINTENANCE; AND
- SOLVENTS USED IN VEHICLE AND EQUIPMENT WASHING.

AFTER CONSTRUCTION ACTIVITIES BEGIN, INSPECTIONS MUST BE CONDUCTED AT A MINIMUM OF AT LEAST ONCE EVERY CALENDAR WEEK AND MUST BE CONDUCTED UNTIL FINAL STABILIZATION IS REACHED ON ALL AREAS OF THE CONSTRUCTION SITE.

IF EXISTING BMPs NEED TO BE MODIFIED OR IF ADDITIONAL BMPs ARE NECESSARY TO COMPLY WITH THE REQUIREMENTS OF THIS PERMIT AND/OR SC'S WATER QUALITY STANDARDS, IMPLEMENTATION MUST BE COMPLETED BEFORE THE NEXT STORM EVENT WHENEVER PRACTICABLE. IF IMPLEMENTATION BEFORE THE NEXT STORM EVENT IS NOT PRACTICABLE, THE SITUATION MUST BE DOCUMENTED IN THE SWPPP AND ALTERNATIVE BMPs MUST BE IMPLEMENTED AS SOON AS REASONABLY POSSIBLE.

A PRE-CONSTRUCTION CONFERENCE MUST BE HELD FOR EACH CONSTRUCTION SITE WITH AN APPROVED ON-SITE SWPPP PRIOR TO THE IMPLEMENTATION OF CONSTRUCTION ACTIVITIES. FOR NON-LINEAR PROJECTS THAT DISTURB 10 ACRES OR MORE THIS CONFERENCE MUST BE HELD ON-SITE UNLESS THE DEPARTMENT HAS APPROVED OTHERWISE.

ACRES OR MORE THIS CONFERENCE MUST BE HELD ON-SITE UNLESS THE DEPARTMENT HAS APPROVED OTHERWISE.

CONTRACTOR SHALL BE RESPONSIBLE FOR STABILIZATION OF ALL DISTURBED AREAS WITHIN THE PROJECT LIMITS WITH MULCHING/PERMANENT VEGETATION.

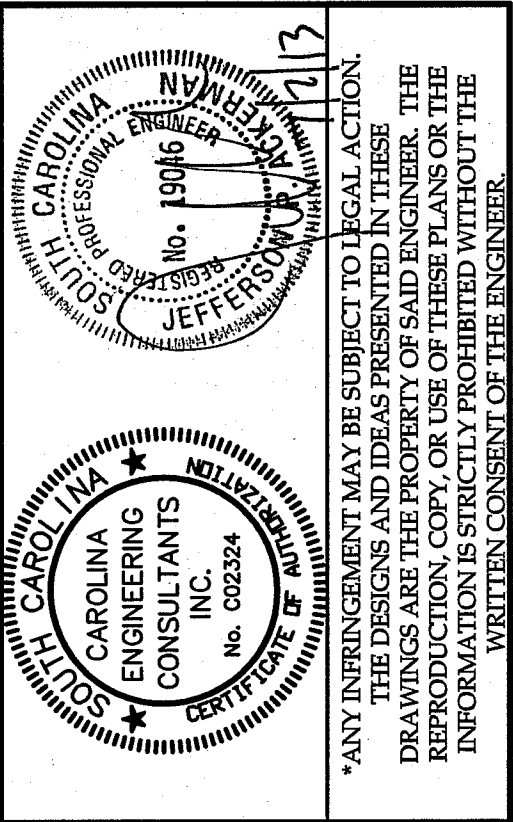
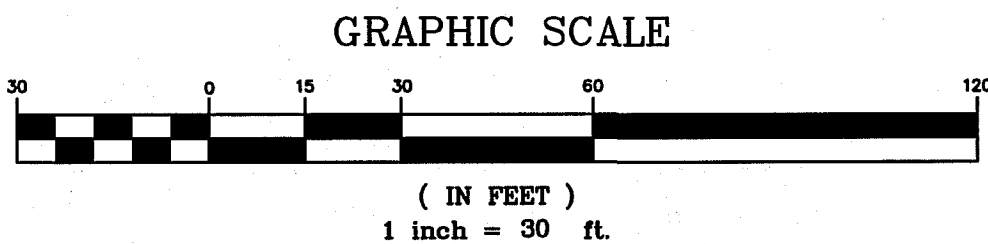

PLAN REVISIONS	
NO.	DESCRIPTION
1	
2	
3	
4	
5	
6	
7	
8	

**FIRE & RESCUE**  
MABEL T. WILLIS BLVD.  
COLLETON COUNTY, SC

**CAROLINA ENGINEERING CONSULTANTS, INC.**  
843/322-0553  
843/322-0556 (FAX)  
WWW.CAROLINAENGINEERING.COM  
PO BOX 294  
BEAUFORT, SC 29901

PROJECT:	1592
DATE:	02/15/13
REVISED:	07/02/13
DRAWN BY:	TAB
ENGINEER:	JPA
SCALE:	1"=30'



MAGNETIC

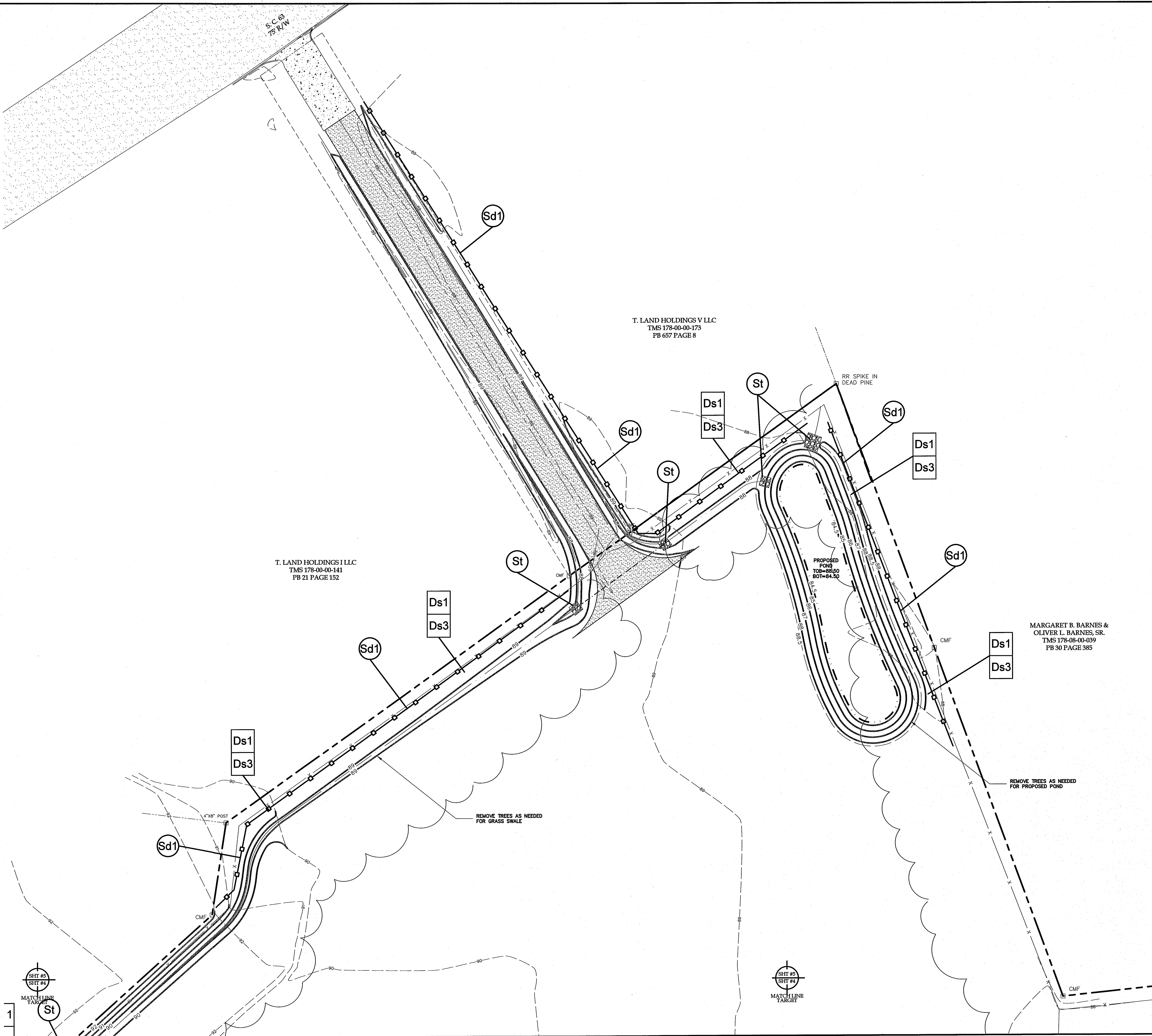
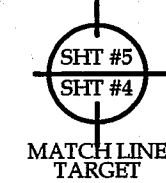
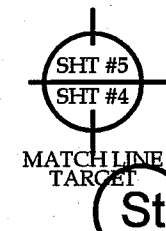
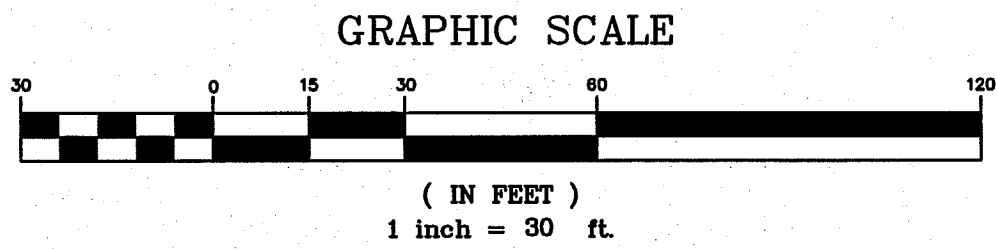

PLAN REVISIONS

NO.	DESCRIPTION	DATE
1	-	-
2	-	-
3	-	-
4	-	-
5	-	-
6	-	-
7	-	-
8	-	-

**FIRE & RESCUE**  
MABEL T. WILLIS BLVD.  
COLLETON COUNTY, SC

**CAROLINA ENGINEERING CONSULTANTS, INC.**  
PO BOX 294  
BEAUFORT, SC 29901

843/322-0553  
843/322-0556 (FAX)

WWW.CAROLINAENGINEERING.COM

PROJECT: 1592  
DATE: 02/15/13  
REVISED: 07/02/13  
DRAWN BY: TAB  
ENGINEER: JPA  
SCALE: 1"=30'

CAROLINA ENGINEERING CONSULTANTS, INC.  
Professional Engineer  
No. 19046  
Jeffrey L. Barnes, Sr.  
Certified Professional Engineer  
No. 00234

\*ANY INFRINGEMENT MAY BE SUBJECT TO LEGAL ACTION.  
THESE DRAWINGS ARE THE PROPERTY OF SAID ENGINEER. THE  
REPRODUCTION, COPY, OR USE OF THESE PLANS OR THE  
INFORMATION IS STRICTLY PROHIBITED WITHOUT THE  
WRITTEN CONSENT OF THE ENGINEER.















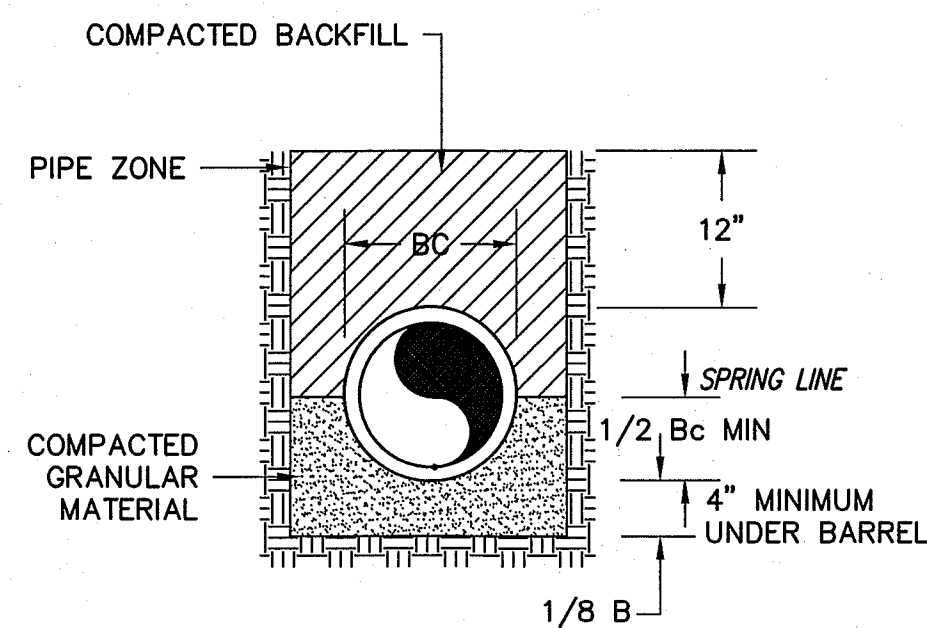

**STORM PIPE BEDDING**  
NOT TO SCALE

NOTE: MARKINGS TO BE THERMOPLASTIC. ALL ARROWS, LINES & WORD MESSAGES SHALL BE AS REQUIRED BY SCDOT IN THE MANUAL ON UNIFORM TRAFFIC CONTROL DEVICES AND THE SCDOT STANDARD DRAWINGS FOR ROAD CONSTRUCTION

**STOP BAR**  
NOT TO SCALE

NOTE:  
COLORS: LEGEND - WHITE (RETROREFLECTIVE)  
BACKGROUND - RED (RETROREFLECTIVE)

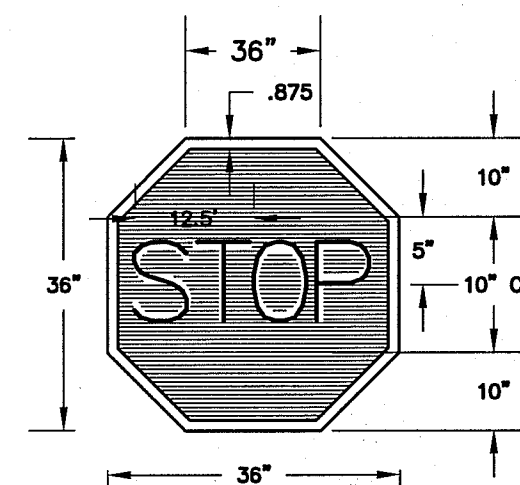

**R-1 STOP SIGN**  
NOT TO SCALE

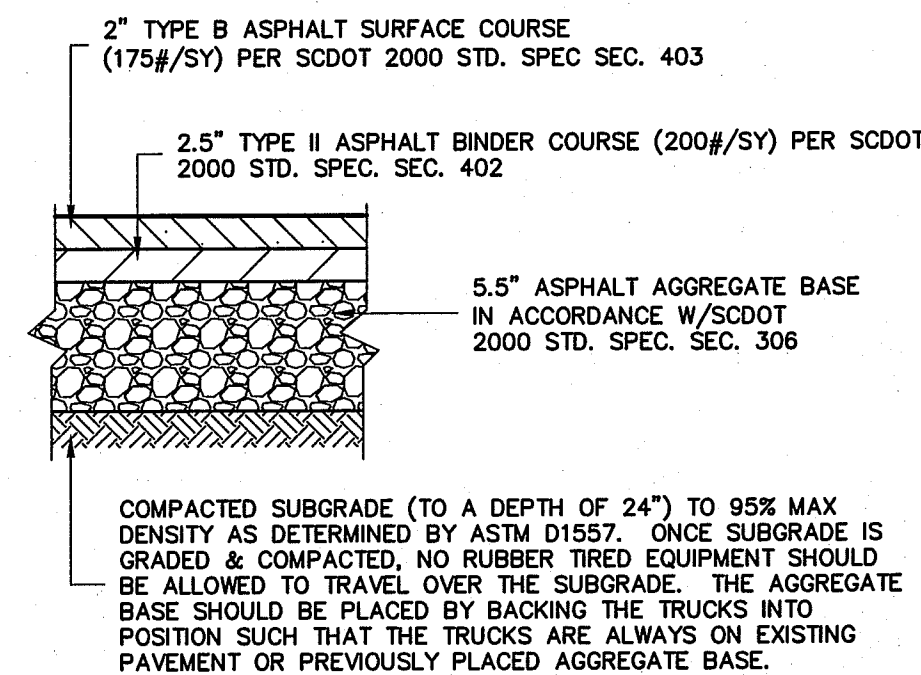

**HEAVY DUTY ASPHALT PAVING DETAIL**  
NOT TO SCALE

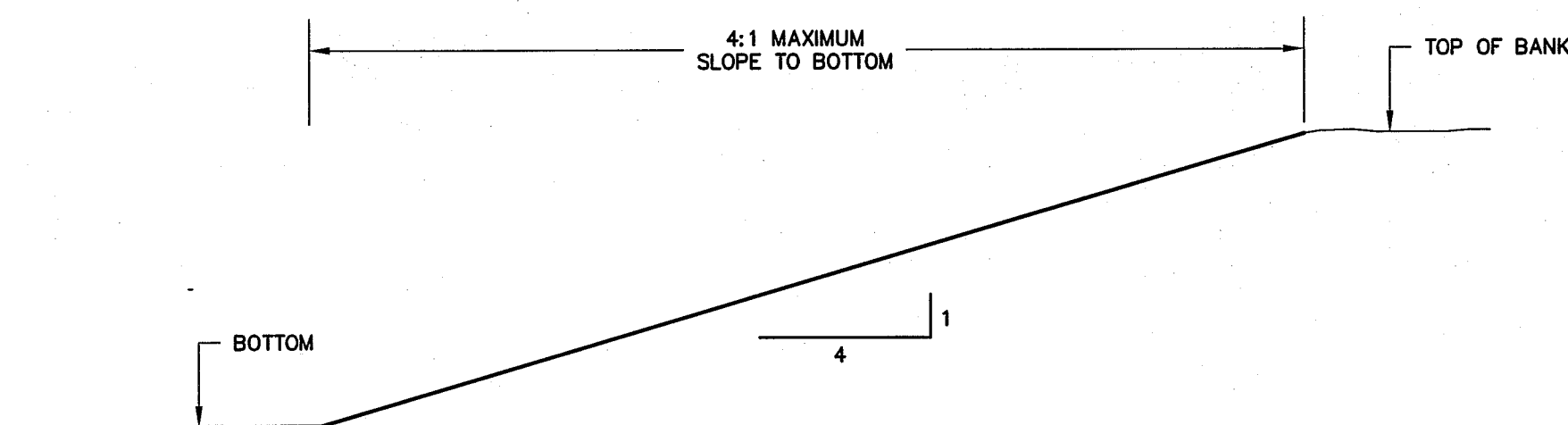

**POND CROSS-SECTION**  
NOT TO SCALE

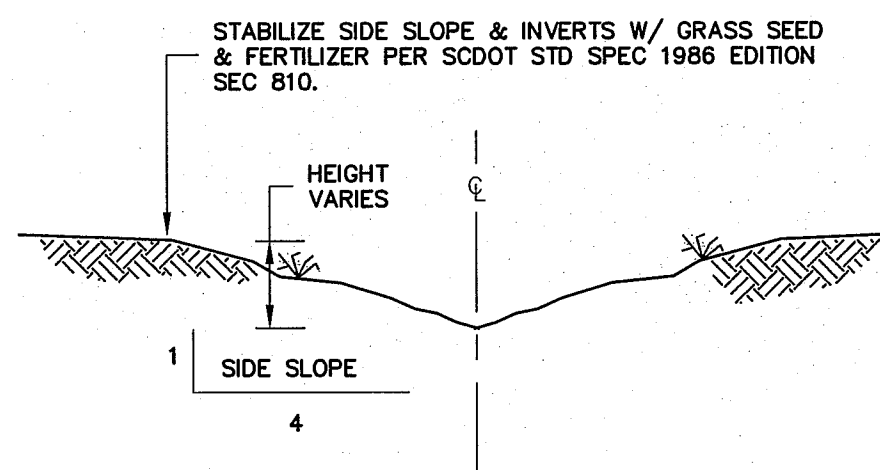

**GRASS SWALE DETAIL**  
NOT TO SCALE

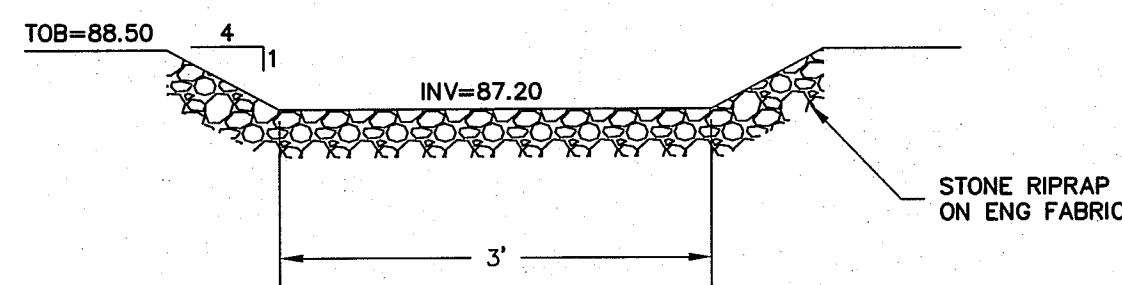

**OUTFALL WEIR**  
NOT TO SCALE

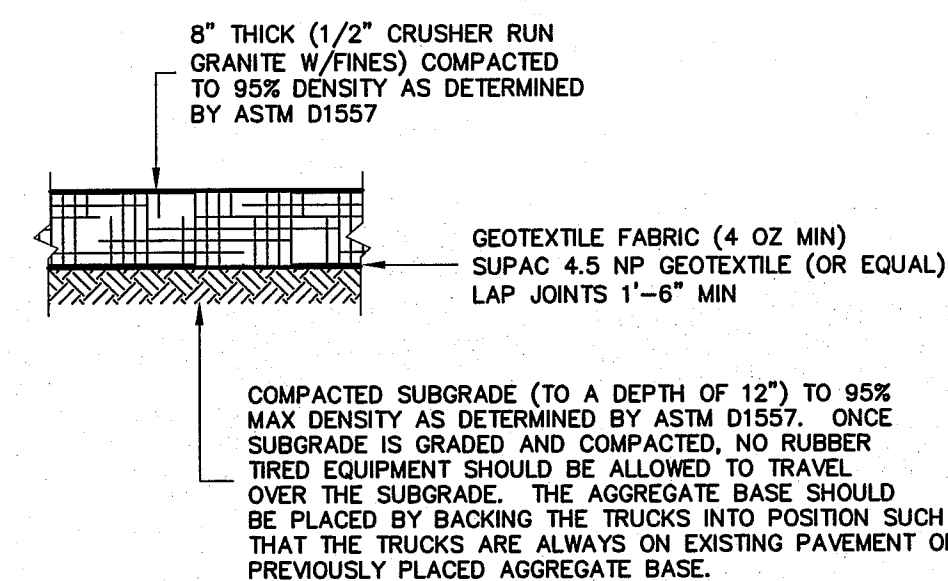

**GRANITE PAVING**  
NOT TO SCALE

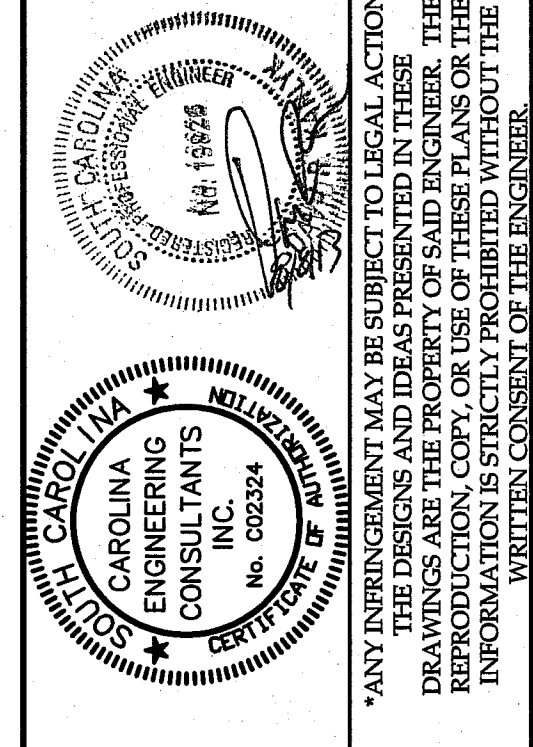

PLAN REVISIONS		DATE
NO.	DESCRIPTION	
1	-	-
2	-	-
3	-	-
4	-	-
5	-	-
6	-	-
7	-	-
8	-	-

**FIRE & RESCUE**  
**MABEL T. WILLIS BLVD.**  
**COLLETON COUNTY, SC**

**CAROLINA ENGINEERING CONSULTANTS, INC.**  
843/322-4553  
843/322-4556 (FAX)  
WWW.CAROLINAENGINEERING.COM  
PO BOX 294  
BEAUFORT, SC 29901

PROJECT:	1592
DATE:	02/15/13
REVISED:	08/09/13
DRAWN BY:	TAB
ENGINEER:	DRK
SCALE:	NTS

**PAVING, GRADING  
& DRAINAGE  
DETAILS**



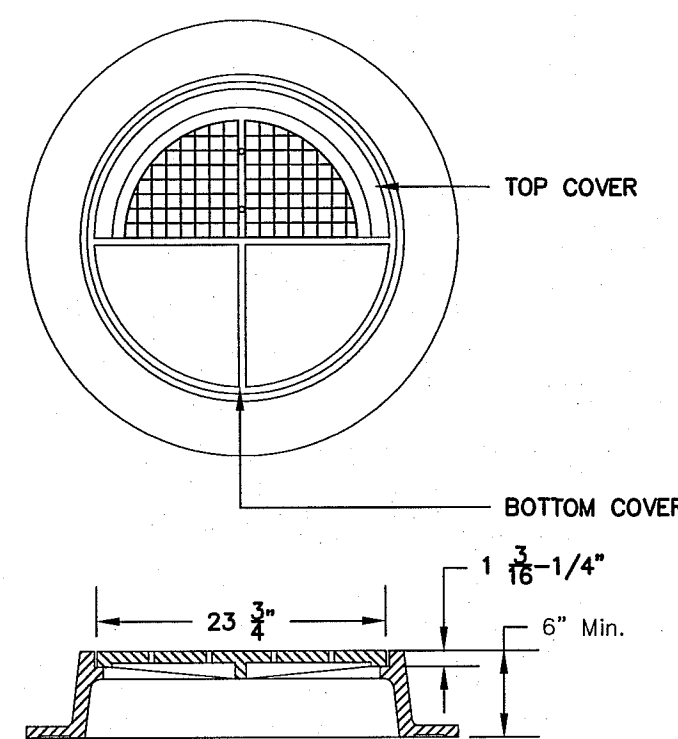

**RURAL MANHOLE  
PROTECTIVE COLLAR**

4,000 PSI CONCRETE COLLAR

FINAL GRADE

2" ABOVE FINAL GRADE

$R=4"$

6" BELOW TOP OF CONE

12"

MANHOLE FRAME AND COVER

USE GRADE RINGS TO ADJUST HEIGHT (10" MAX DISTANCE FROM CONE TOP TO BOTTOM OF RIM)

25 3/4"

4'-0"

5/4D

3/4D

PRECAST CONCRETE, USE MINIMUM NUMBER OF JOINTS

1' MIN.

CONCRETE BRICK AND MORTAR FILLETS

1' MIN.

GRAVEL BASE

**SECTION**

**SCALE**

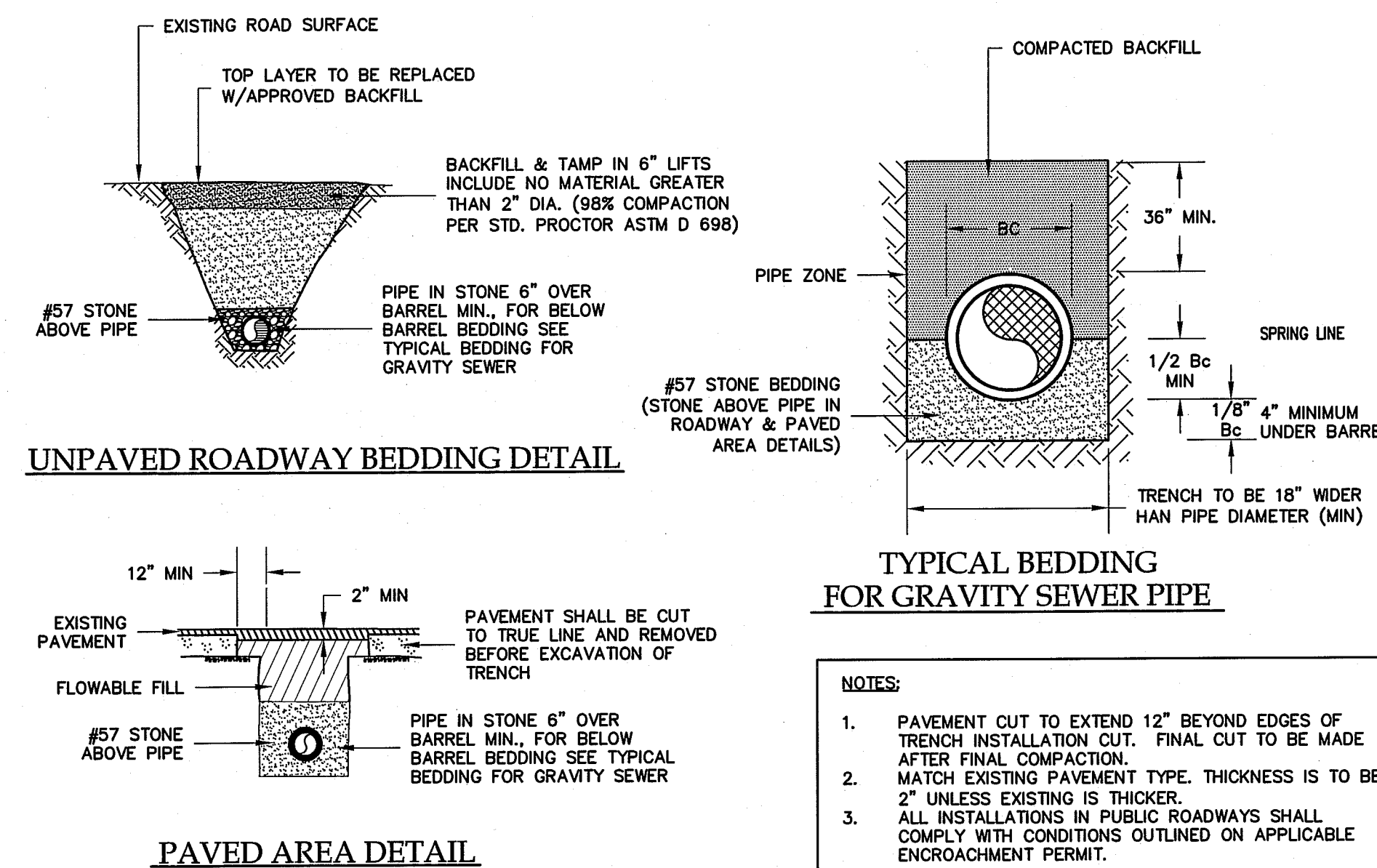

NOT TO SCALE



PLAN REVISIONS		
NO.	DESCRIPTION	DATE
1	-	-
2	-	-
3	-	-
4	-	-
5	-	-
6	-	-
7	-	-
8	-	-

**FIRE & RESCUE**  
MABEL T. WILLIS BLVD.  
COLLETON COUNTY, SC

**CAROLINA ENGINEERING CONSULTANTS, INC.**  
PO BOX 294  
REARPORT SC 29901  
843/322-0553  
843/322-0556 (FAX)  
WWW.CAROLINAEENGINEERING.COM

PROJECT:	1592
DATE:	02/15/13
REVISED:	07/02/13
DRAWN BY:	TAB
ENGINEER:	JPA
SCALE:	NTS

## WATER & SANITARY SEWER DETAILS

10  
OF 10

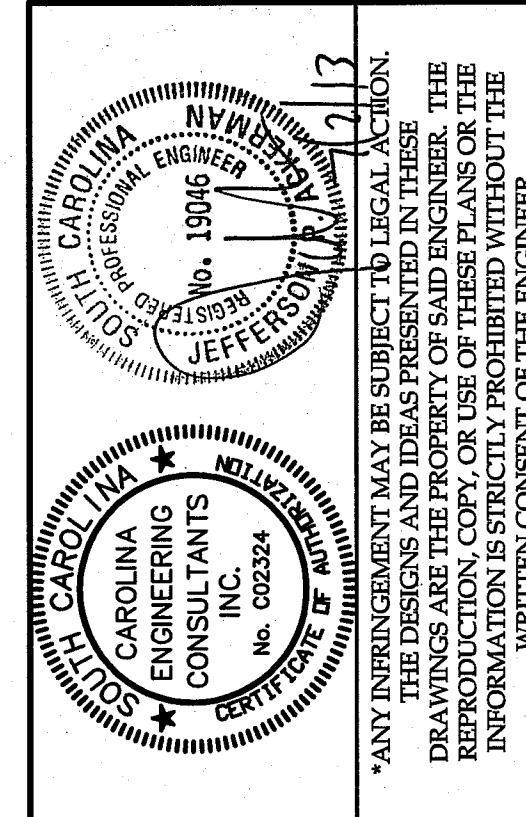

\*ANY INFRINGEMENT MAY BE SUBJECT TO LEGAL ACTION.